

# HealthCare Cold medicine storage

# Hygiene Solutions

## Hygienic Wall and Ceiling Solutions

### Main Issues in Cold Medicine Storage:

Cold Medicine Storage is critical for storage of many different types of medication and is critical to remain at a high hygienic standard. Standard walls face the following issues:

- Surfaces which are not biologically resistant
- Moisture damage on ceilings and walls due to requirement for heavy cleaning
- Mold and Mildew Growth
- Particle and air quality emissions from standard wall claddings
- Most Surfaces are not cleanroom certified



## Recommended Finishes

### Glasbord® with Surfaseal® for Walls and Ceilings

Hygienic Glasbord® with Surfaseal®  
Wall panels by Crane Composites®

- Smooth / Embossed Finish
- 1.5mm / 1.9mm / 2.3mm Thick
- Fire Rating: Class C / Class B / Class A / FM Approval
- Available in 1.20m width to any length required, Can be made up to 2.4m Width.
- Color Match is available

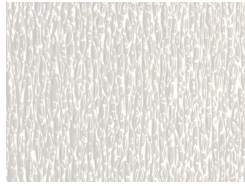

Embossed White | 85

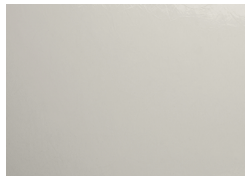

Smooth White | 85



Main Issue	How Glasbord® with Surfaseal® Provides a solution
Surfaces are not Cleanroom certified and are not biologically resistant	Glasbord® with Surfaseal® is CSM certified with a Biological resistance of excellent.
Hi levels of damage on walls due to heavy duty cleaning, mold and mildew growth	Glasbord® with Surfaseal® is extremely wearing and resistant to heavy cleaning. It is also completely waterproof and a pore free surface. It is also highly impact and scratch resistant.
Particle and air quality emissions from standard wall claddings	Glasbord® with Surfaseal® is ISO class 5.

## Benefits

- ✓ Completely non porous surface, highly washable and stain resistant
- ✓ Chemical Resistant and resistant to repetitive heavy duty cleaning
- ✓ Mold and mildew free
- ✓ High impact and scratch resistance
- ✓ Easy and quick to install
- ✓ HACCP certified
- ✓ Fire rated: Class C , Class A and FM global
- ✓ UL GreenGuard Gold product certified for low chemical emissions
- ✓ Extremely washable and supports repetitive cleaning process.

## Certifications



# HealthCare Cold medicine storage

## Hygienic Wall and Ceiling Solutions

### Installation Options / Engineered Solutions



Glasbord® with Surfaseal® Self Adhesive peel and stick panels (Hygibreak®)



Glasbord® with Surfaseal® laminated on Rigid Board (Hygimat)



Glasbord® with Surfaseal® Sandwich Panels (Hygispan®)

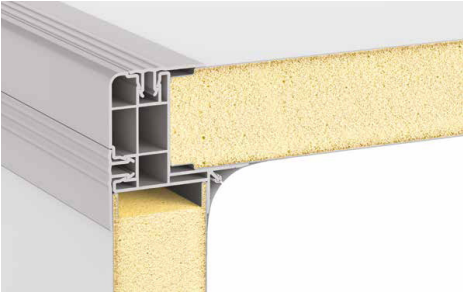

Glasbord® with Surfaseal® Modular Panels (Hygicold)



Traditional Installation

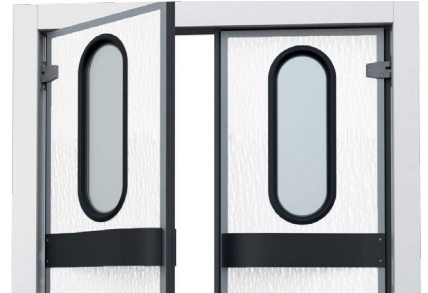

Custom Made Hygienic Doors (Hygidoor)

### Profiles and Accessories

- PVC profiles (division bars, inside corners, outside corners)
- Stainless Steel Profiles
- Safety Barriers
- Polyurathane seam sealant
- Heavy duty skirting
- Suspended Ceiling Grid



PVC Profiles



Polyurathane Seam Sealant



Heavy duty Skirting



Safety Barriers

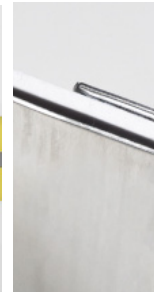

Stainless Steel Profiles



Suspended Ceiling Grid

